



Palm Park Design & Community Conversations

Context: Waterloo Greenway



Lady Bird Lake

Butler Trail

Waterloo Greenway Trail

Palm School

Waller Creek

Waterloo Park

Palm Park



Context: Waterloo Greenway



Palm School

Waller Creek +
Waterloo Greenway

PALM PARK

< 2 Acres

CESAR CHAVEZ

4TH ST

3RD ST

IH-35

Context: Palm Park

- 1 Respect Palm Park's History, Including the Shelter House
- 2 Maintain Potential for Connection to Palm School
- 3 Incorporate Existing Trees
- 4 Connect to Waterloo Greenway's Main Trail System + Creek Landscape
- 5 Requirements for Separation of Play Components
- 6 Carefully Consider Existing Roadway Edges and Future Connections



Community Feedback

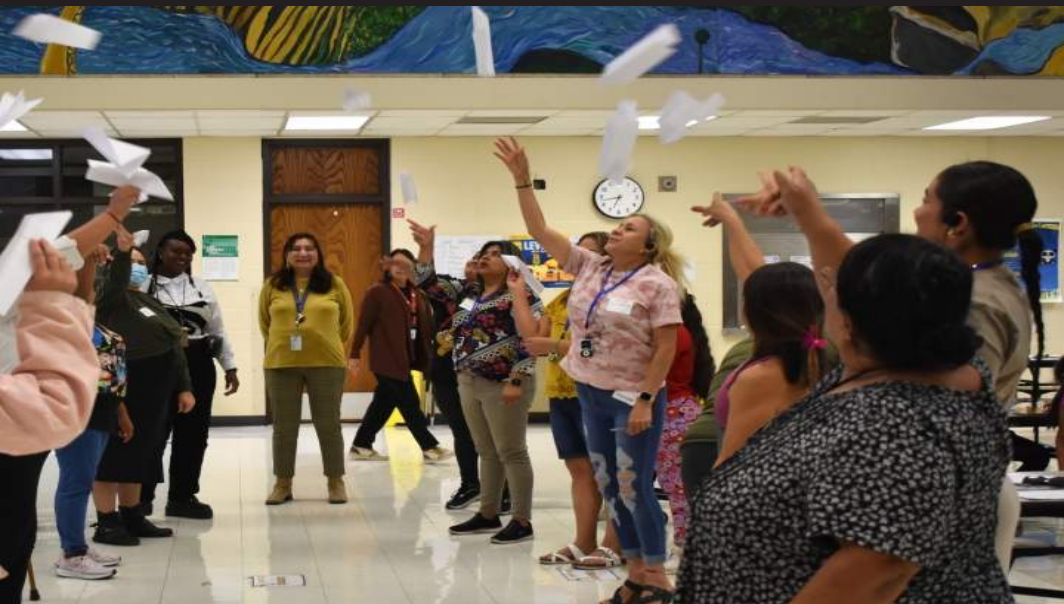

Community Comment Themes

Park Trees

Family & Play

Gathering Space

Places of Memory

Community Identity

Park Trees

"Connection with nature, diverse plants and animals"

"Tree canopies over trails"

"Storytelling"

"Story time space: regular program for kids, story circle by oak"

"Educational nature walks for children and adults"

"Places for respite from urban spaces"

"Shade! Lots of trees"

"Honor the history and meaning behind the pool (share memories of the community)"

"BBQ, picnics, parties - birthdays, music, reunions, celebrations"

"Shade and materials such as grills to prepare food; tables and chairs"

"Smaller, more flexible features to allow more informal, community-driven activities"

"Space for cultural events"

"Terrace seating"

"Family friendly spaces to gather"

"Smaller areas for family gatherings and individual seating"

Gathering Space

"Picnic tables that can be moved around but also well-maintained"

"Moveable seating, ability to shift around"

"Eat and drink, share stories, laugh"

"Being able to spend quality time with family and friends"

"Some sort of deck"

"Replace missing pool with something to reflect its importance"

"Lots of shade and spaces to stop and rest"

"Commemorate history of the pool"

"Put water feature where pool used to be"

Places of Memory

"Record where swimming pool and movies used to be. Show history"

"Preserve notion of functionality embedded in original structure"

"Save the initial architecture and function it with the current fashion"

"Lending library"

"Slab for children's games"

"Water fountains, restroom building"

"Four-square"

"Keep historic structures"

Family & Play

"Equipment for all ages, especially babies"

"Water play"

"Sensory play; sound and movement"

"Kinetic play sculpture, play features, musical instruments"

"Water elements and splash pads are important in the heat"

"Open space/ play, exploration"

"Splash pad, could be a water feature on the ground, waterfall/ creek, mimics nature"

"Nature playground, tree house"

"Murals, monuments"

"Integrate colors that are representative of the past"

"Mexican-American heritage should be honored and celebrated"

"Walking gardens to enjoy flowers and vegetation (a meaningful destination)"

"Flowers, plants and animals"

Community Identity

"Invite local artists (part of the community)"

"Tell the story of the park, the neighborhood, those that lived there"

"Visual art; art/sculptures"

"Mosaics, sculpture, spaces to sit and contemplate"

"Family gathering"

"Playscapes"

"Reading space, children's events and storytelling"

"Nature water feature, natural, exploratory"

"Water feature; learning space about water for kids in Austin"

Park Trees: Building a Green City

Park Trees

"Educational nature walks for children and adults"

"Tree canopies over trails"

"Connection with nature, diverse plants and animals"

"Places for respite from urban spaces"

"Shade! Lots of trees"

"Story time space: regular program for kids, story circle by oak"

"Storytelling"

Creek Landscape is the Front Door of Palm Park



195,000 plants, including over 1,600 new trees, will be planted as part of the Confluence project



Planting the Future Tree Canopy



 Preserve

 Plant



The "Story Tree"

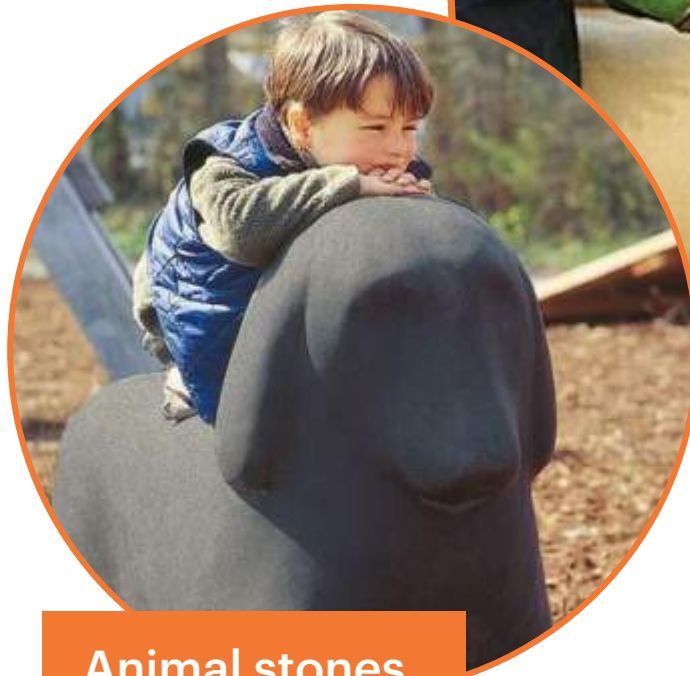
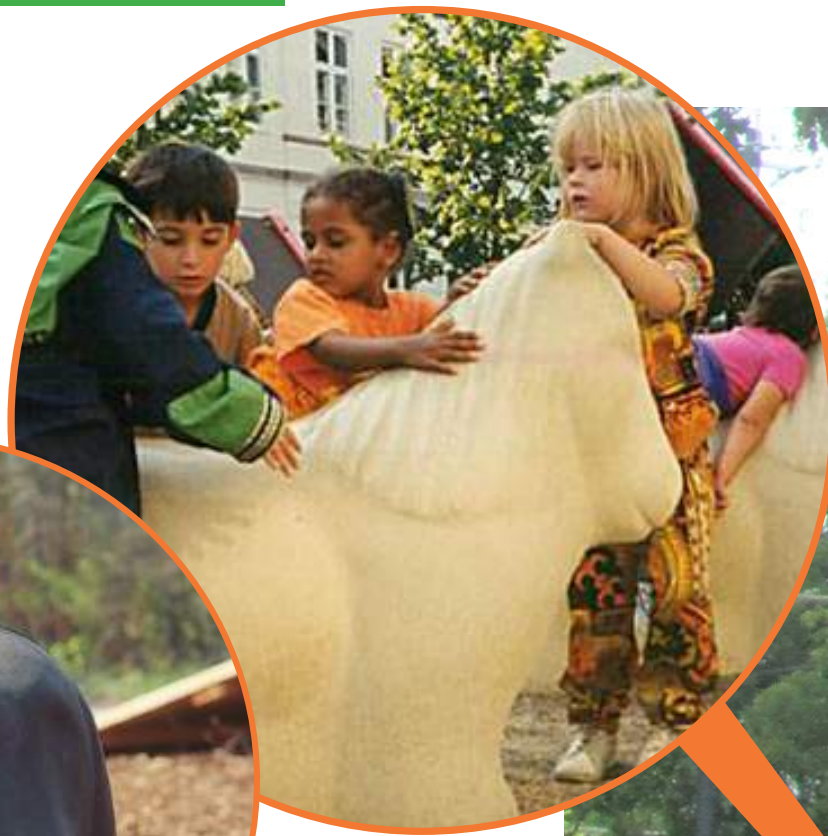

Animal stones

Canopy drip line

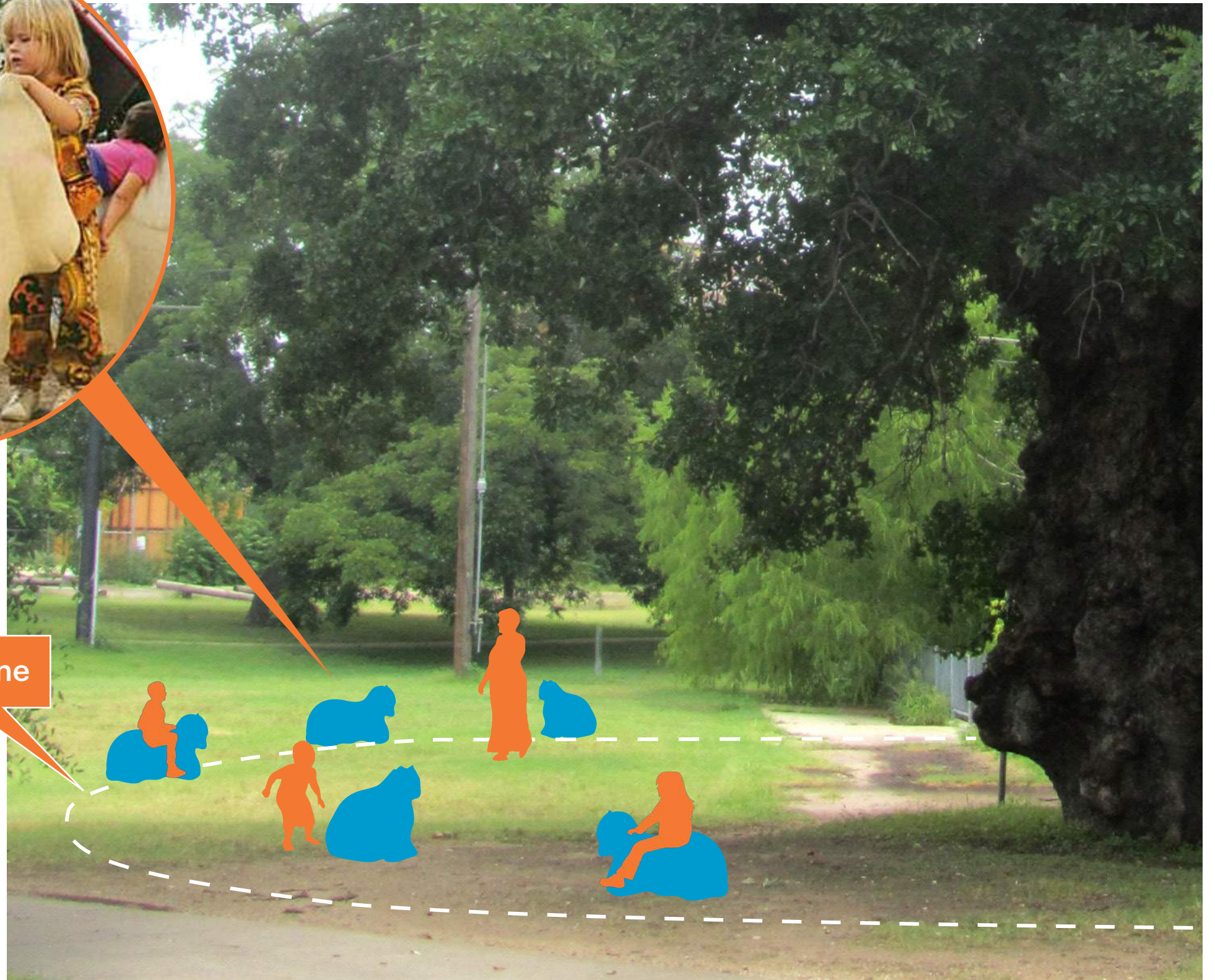

Palm Park Program: Park Trees

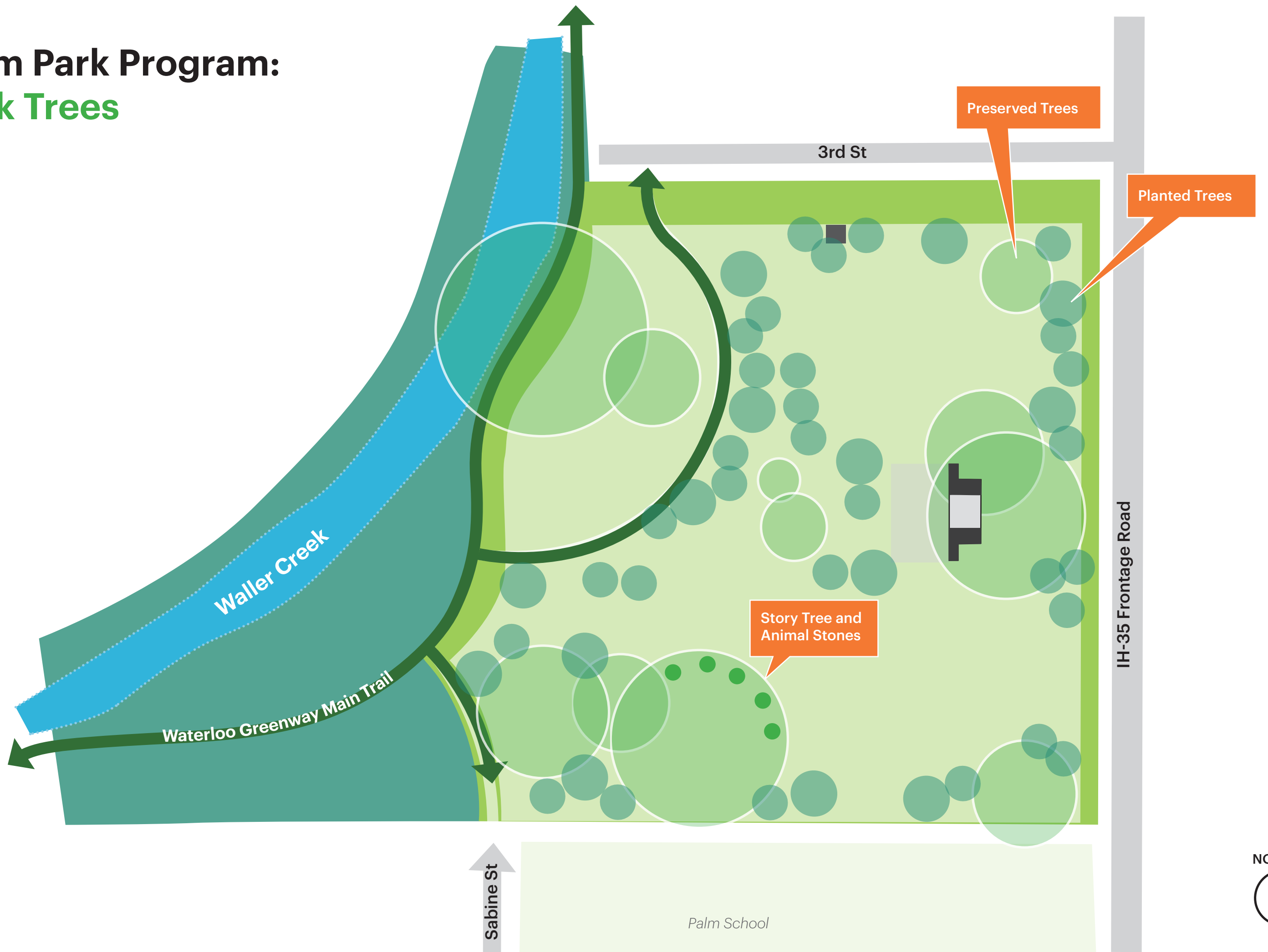

Family & Play: Breathing Life Into the Park

Family & Play

"Equipment for all ages, especially babies"

"Nature water feature, natural, exploratory"

"Reading space, children's events and storytelling"

"Family gathering"

"Sensory play; sound and movement"

"Kinetic play sculpture, play features, musical instruments"

"Playscapes"

"Flowers, plants and animals"

"Nature playground, tree house"

"Open space/ play, exploration"

"Water play"

"Splash pad, could be a water feature on the ground, waterfall/ creek, mimics nature"

"Water elements and splash pads are important in the heat"

"Water feature; learning space about water for kids in Austin"

Nature Play



Sensory Play



The Nest



Scramble Path



Stick Lab

Family Space



Play area

Caregiver area



Caregiver area

Play Area
Ages 5-12

Play Area
Ages 2-5

Nature Play

Separation of
age groups



Playscape Inspiration: Texas Animals



Jaguarundi



Trans-Pecos Scorpion



Armadillo



Nutria



Mexican Long-Nosed Bat

"Flowers, plants and animals"



Texas Blind Salamander



Javelina



Gray Fox



Grackle



Snapping Turtle



Bald Eagle



Alligator Gar



Porcupine



Nilgai

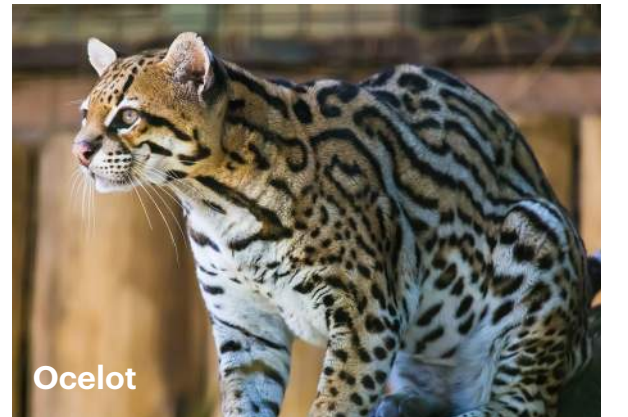

Ocelot



Green Treefrog



Texas Horned Lizard



Black-Footed Ferret



Tarantula



Albino Rattlesnake

Playscape Inspiration: Texas Animals

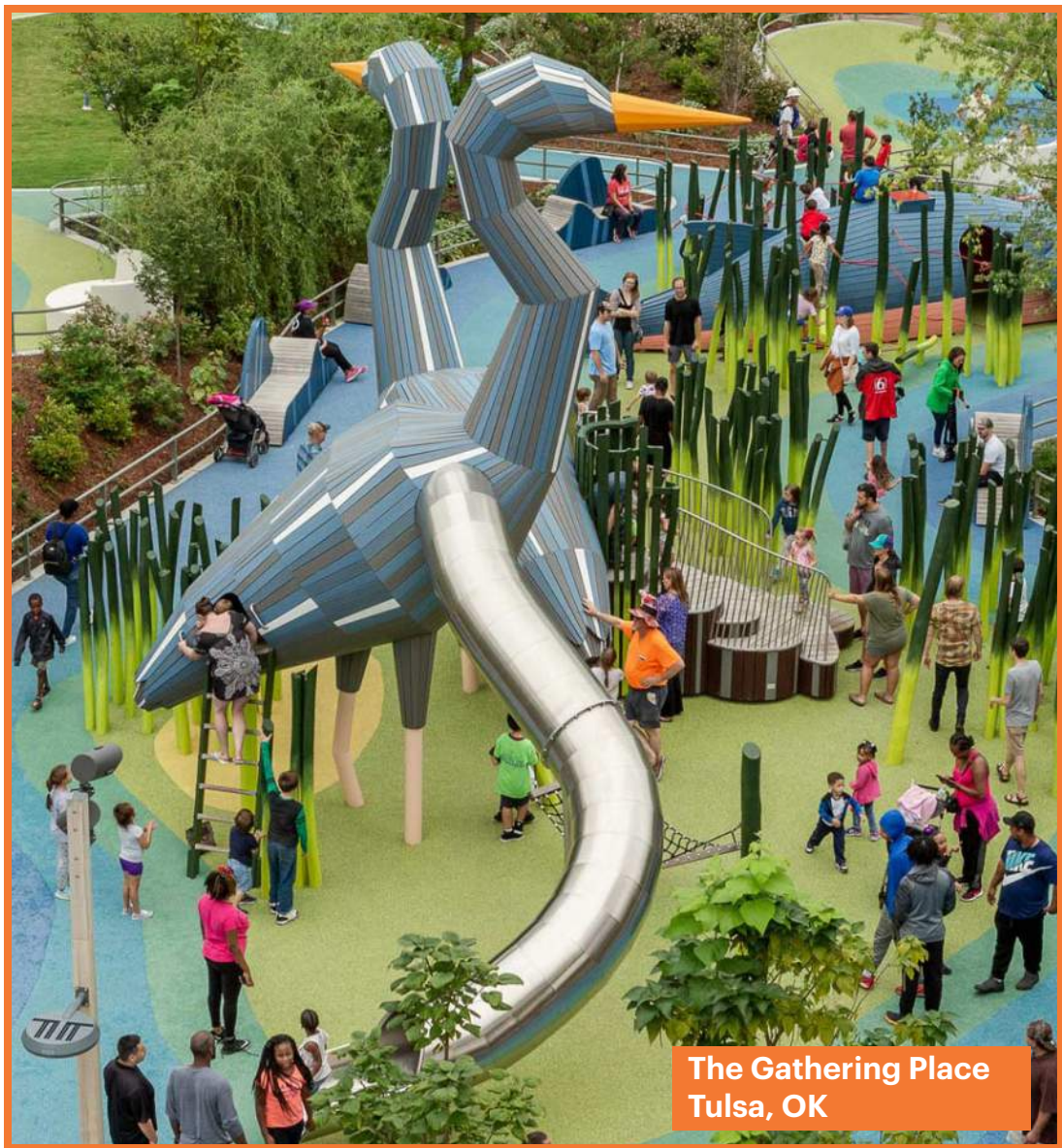
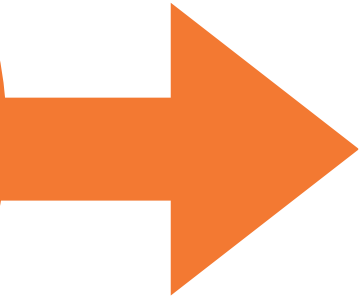

Playscape Inspiration: Texas Animals

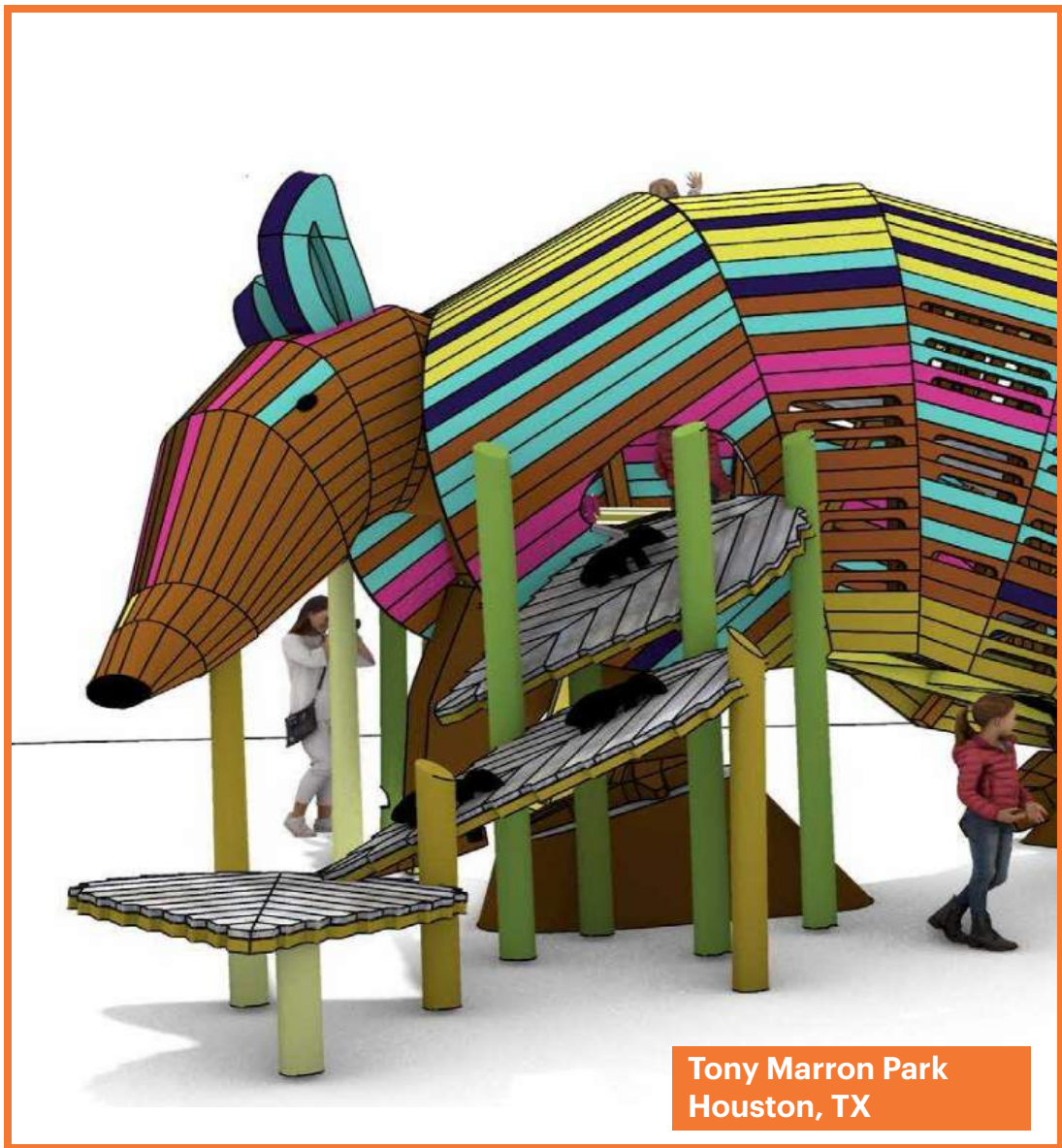
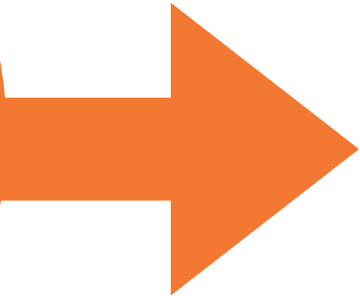

Tony Marron Park
Houston, TX

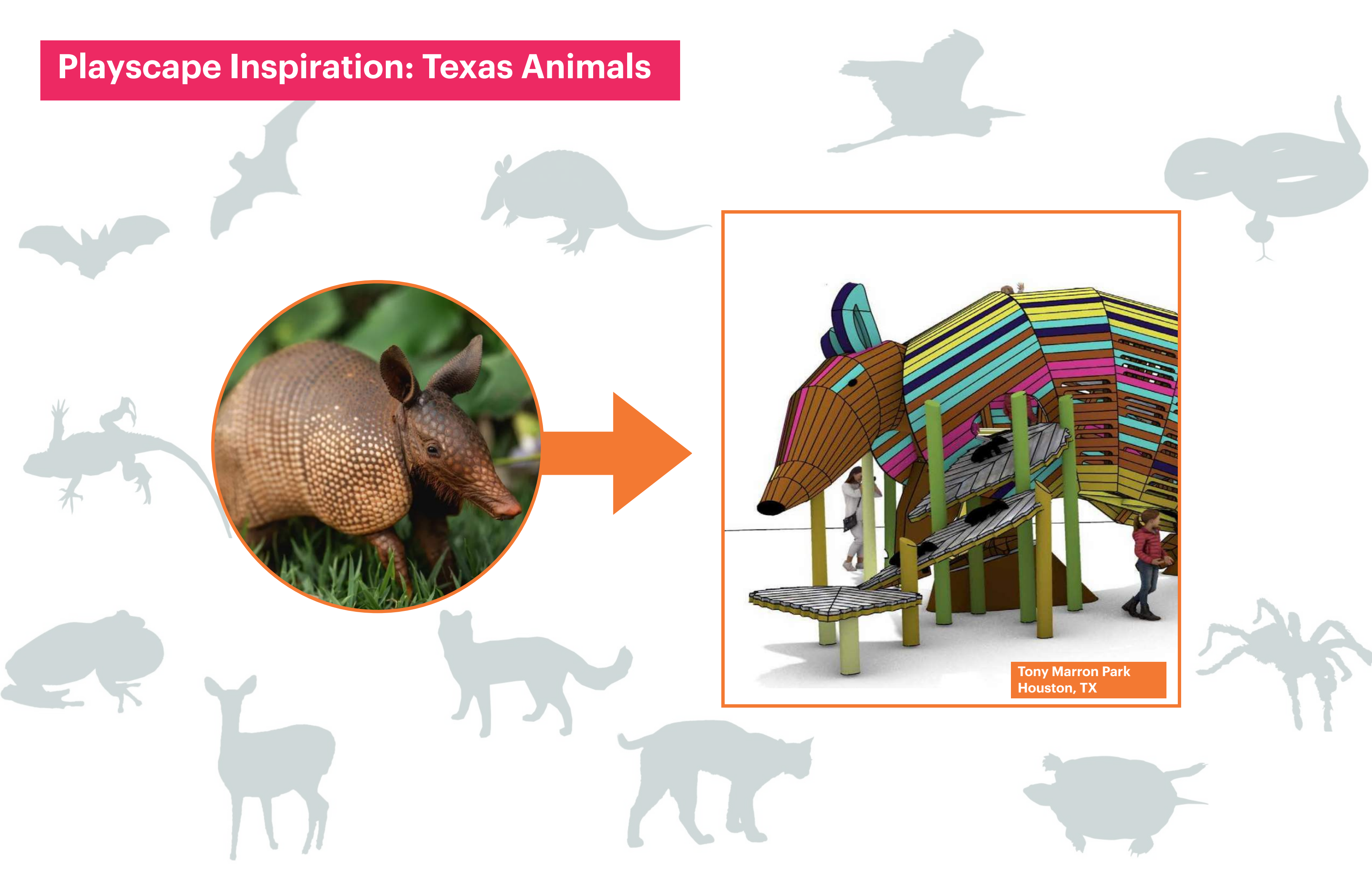

Playscape Inspiration: Animals

Tapping into the imagination of the community's children



workshop

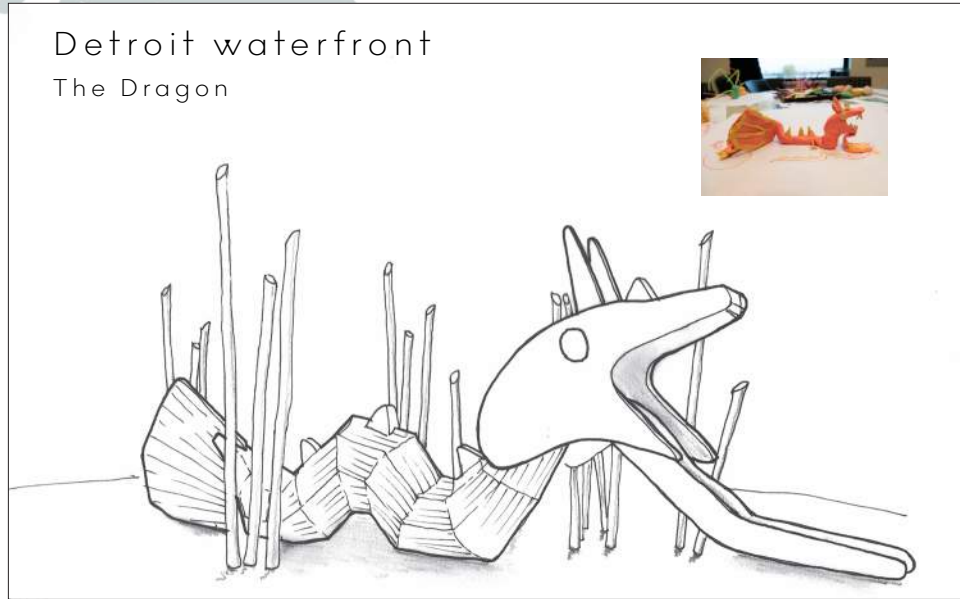

concept sketch

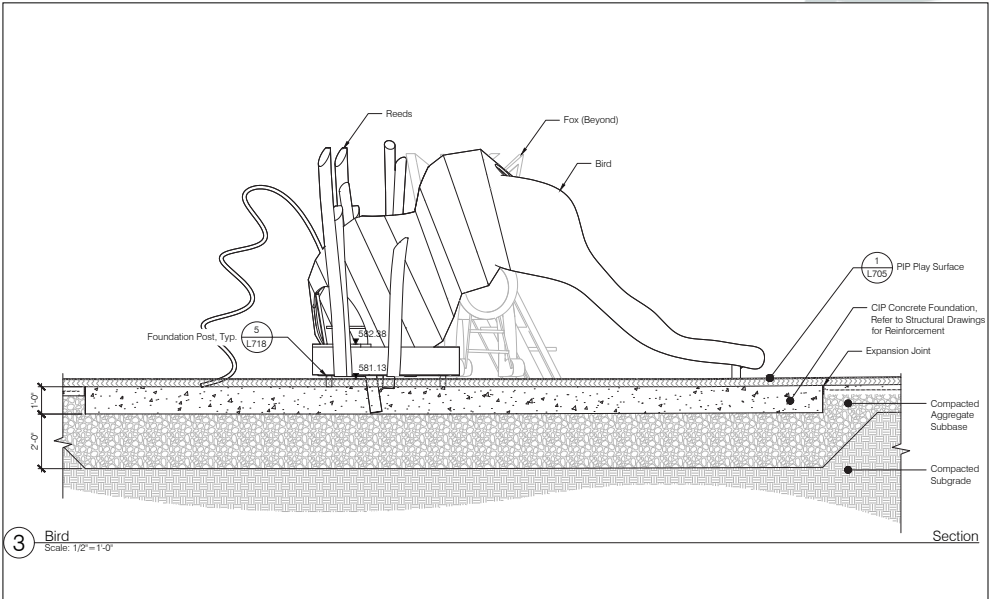
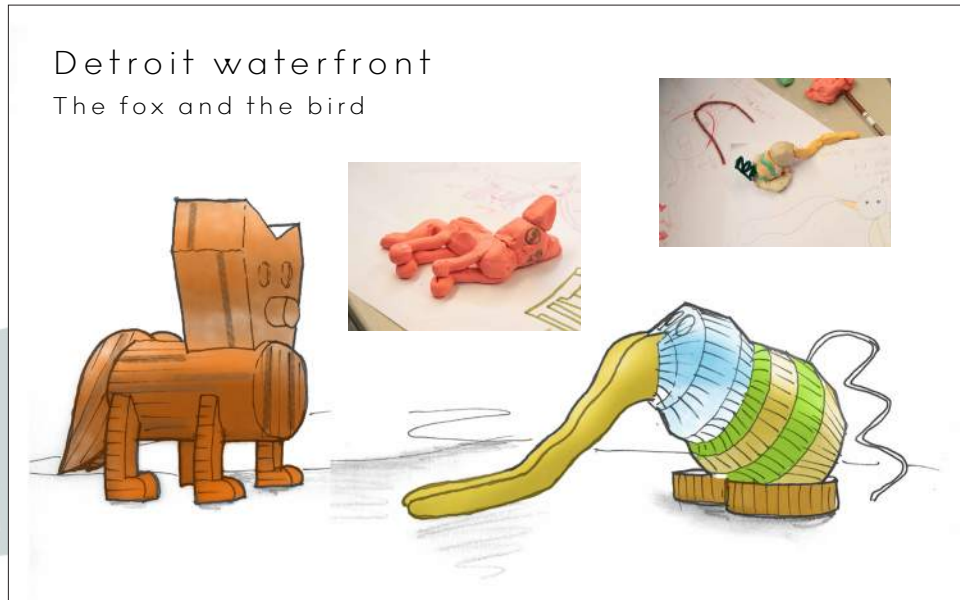

design + documentation

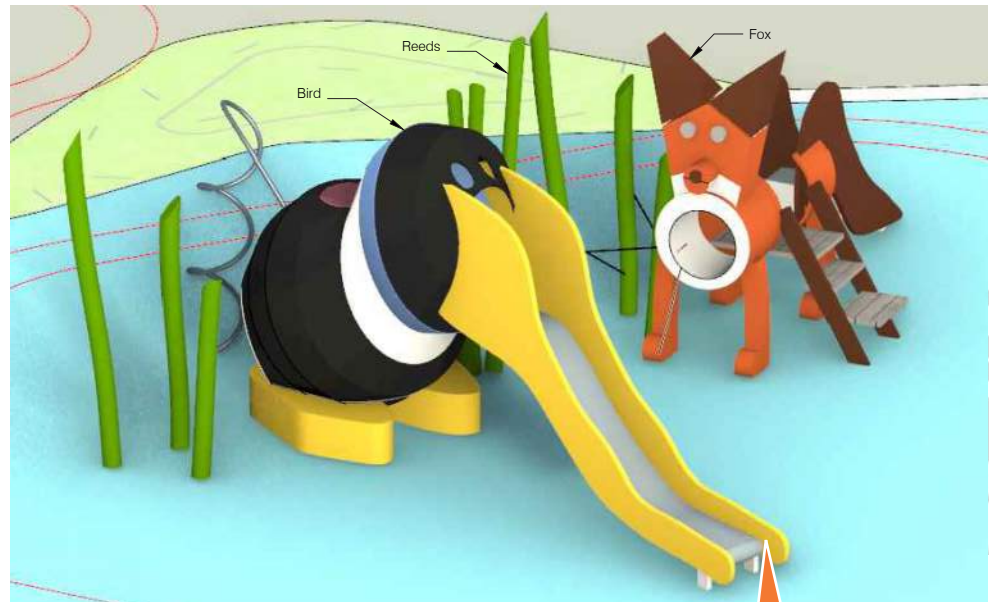

Monstrum play equipment currently under development in Detroit riverfront park

Misting Field Water Feature

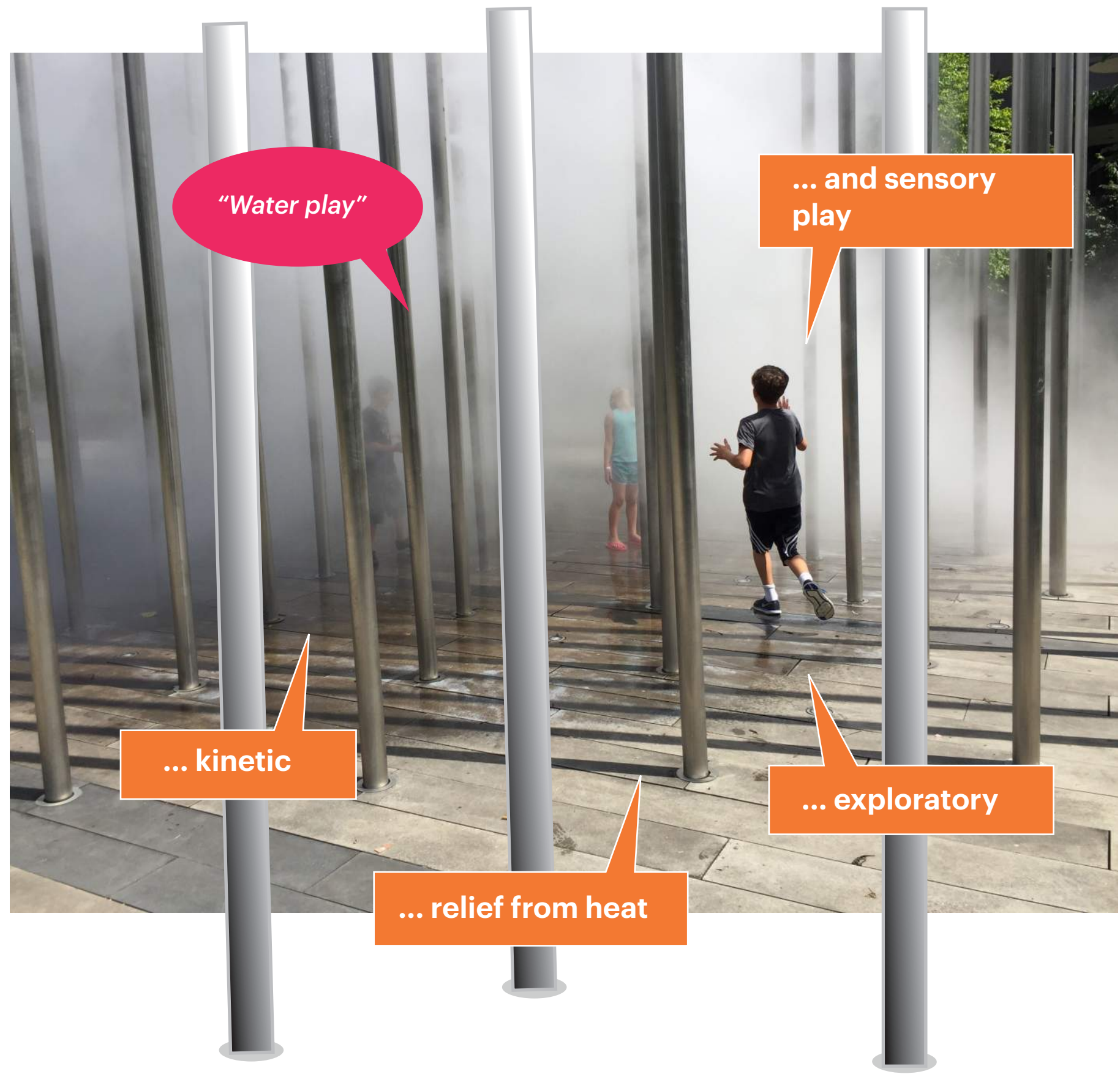

"Water play"

... and sensory play

... kinetic

... relief from heat

... exploratory

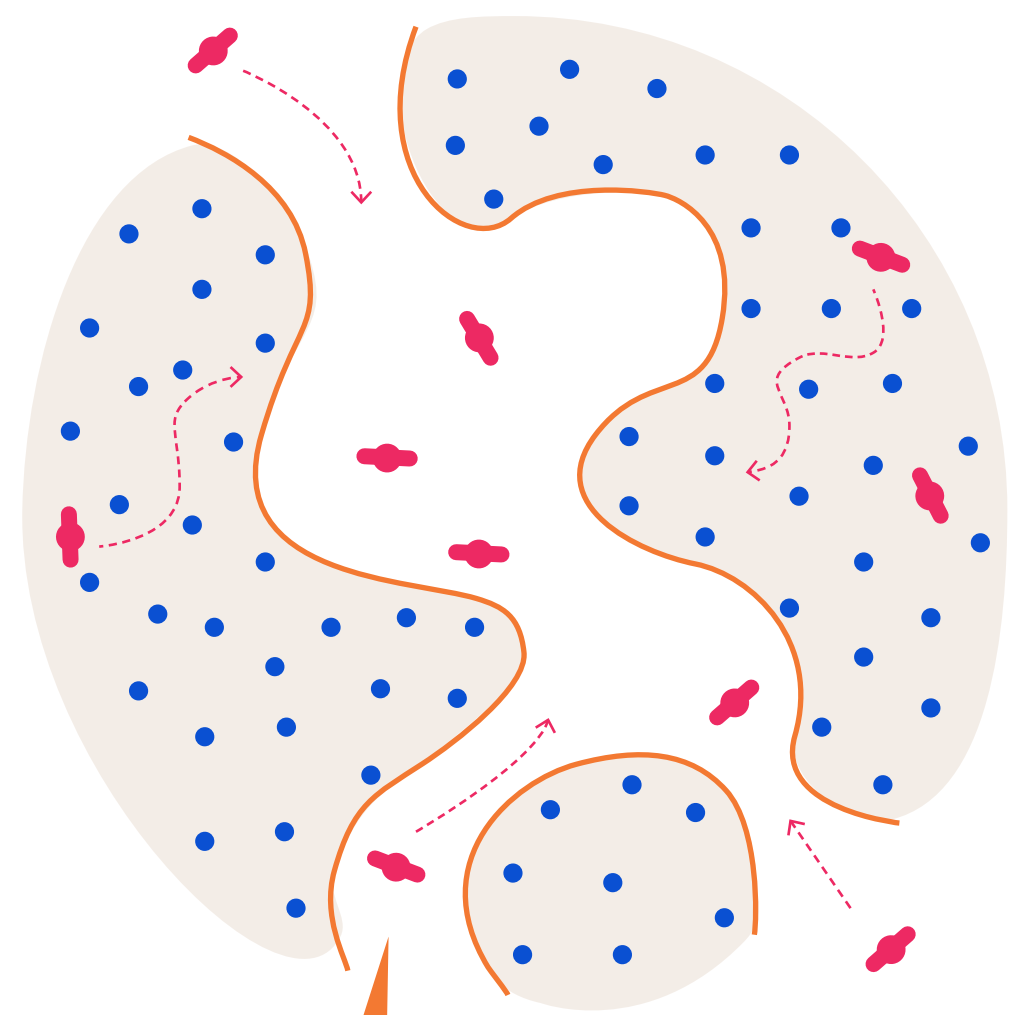

Place to be immersed inside

Palm Park Program: Family & Play

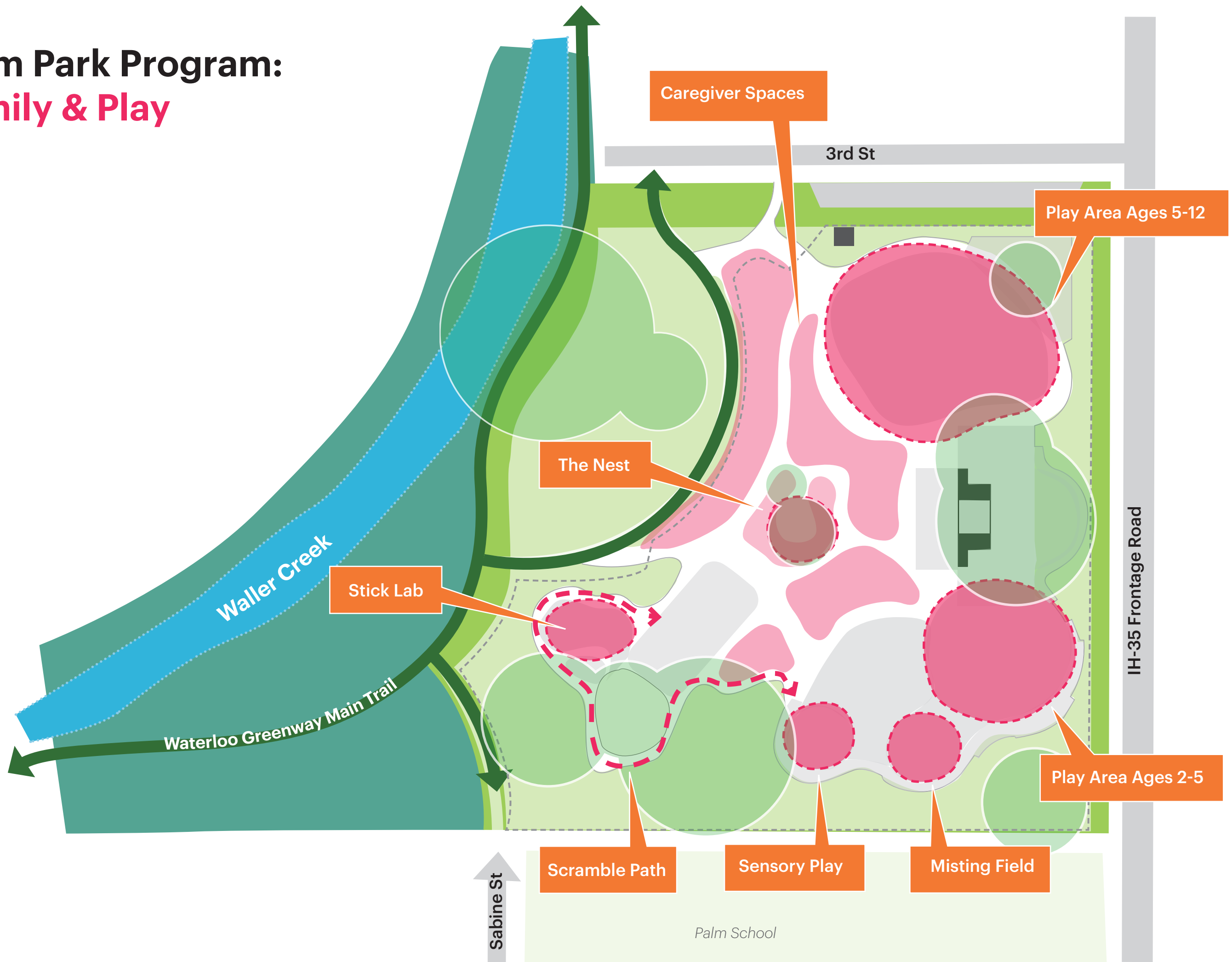

Gathering Space: Embracing a Diversity of Activity

Gathering Space

*"BBQ, picnics,
parties - birthdays,
music, reunions,
celebrations"*

"Some sort of deck"

*"Shade and materials
such as grills to
prepare food; tables
and chairs"*

*"Eat and drink, share
stories, laugh"*

*"Smaller, more flexible
features to allow more
informal, community-driven
activities"*

*"Being able to spend
quality time with family
and friends"*

*"Space for cultural
events"*

*"Terrace
seating"*

*"Moveable seating,
ability to shift around"*

*"Family friendly
spaces to gather"*

*"Smaller areas for
family gatherings and
individual seating"*

*"Picnic tables that can be
moved around but also
well-maintained"*

Gathering Space



Open Lawn



Tree Decks



Moveable Furniture

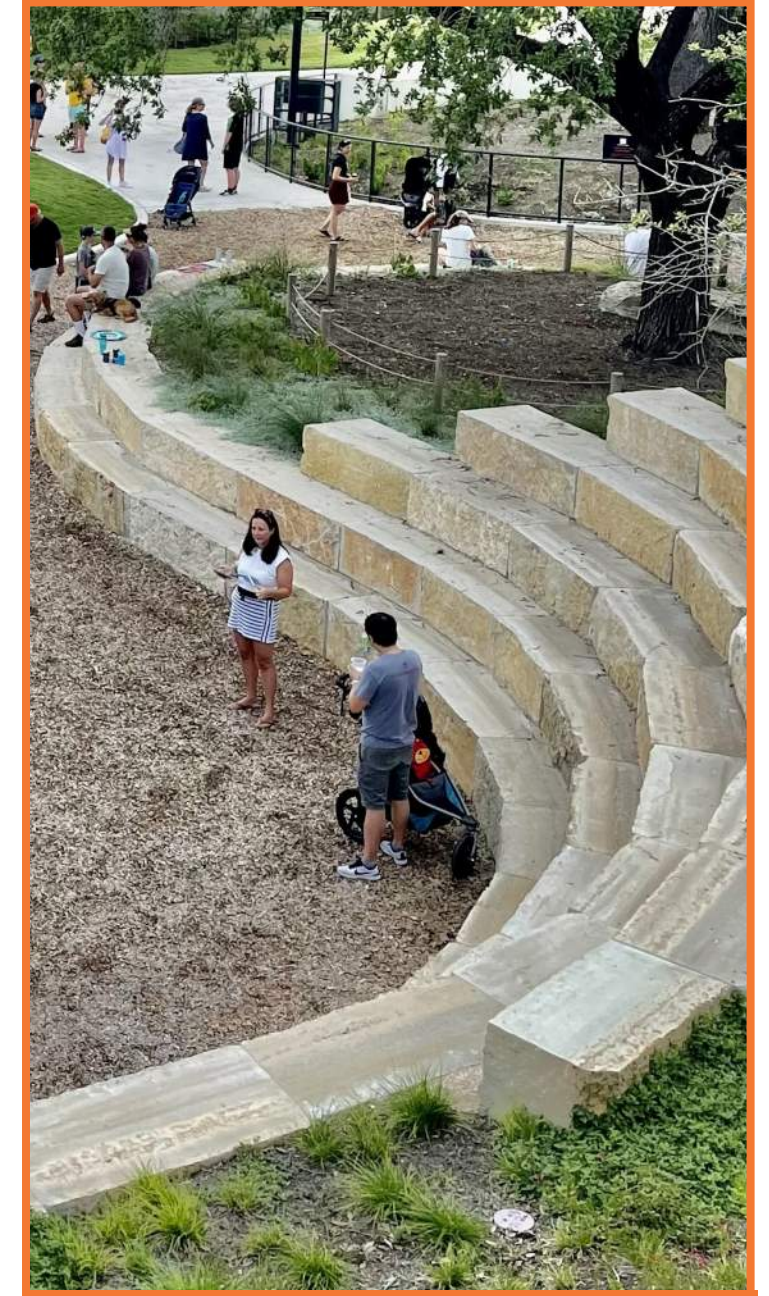

Terrace Seating

Palm Park Program: Gathering Space

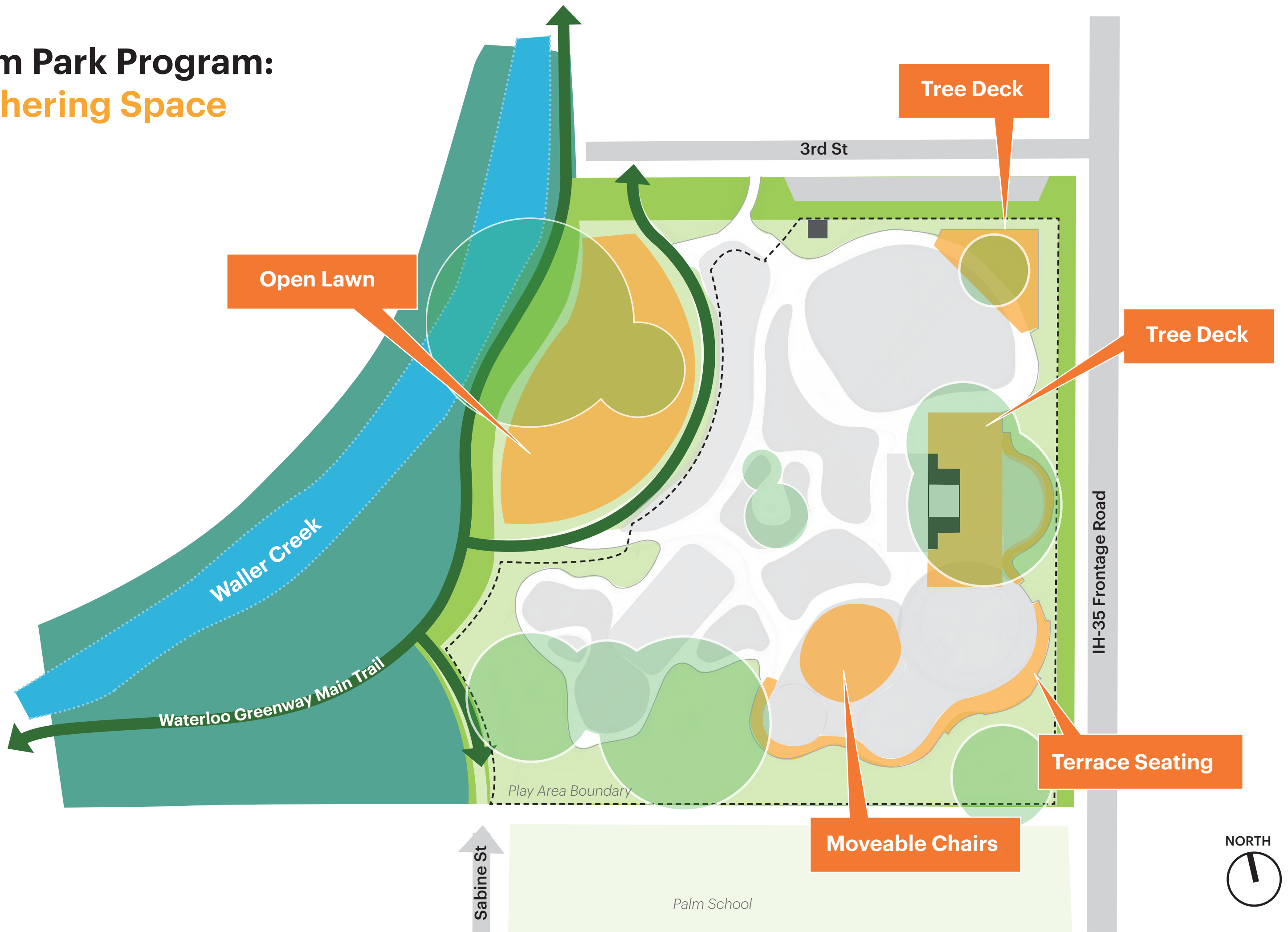

Places of Memory: Honoring Historic Features

Places of Memory

"Keep historic structures"

"Replace missing pool with something to reflect its importance"

"Save the initial architecture and function it with the current fashion"

"Water fountains, restroom building"

"Record where swimming pool and movies used to be. Show history"

"Preserve notion of functionality embedded in original structure"

"Lots of shade and spaces to stop and rest"

"Put water feature where pool used to be"

"Honor the history and meaning behind the pool (share memories of the community)"

"Slab for children's games"

"Commemorate history of the pool"

"Four-square"

"Lending library"

Shelter House



Shelter House



Historic roof is not feasible to rebuild without costly impacts to walls...

... but the concrete / stone veneer construction is quite stable

Shelter House

A “halo” roof floating over the structure offers numerous benefits including more shade, natural air circulation, and highlighting the craft of the original stonework



Shelter House

Light can be reflected off of the halo's underside for better lighting around the shelter house for safety and atmosphere



Shelter House

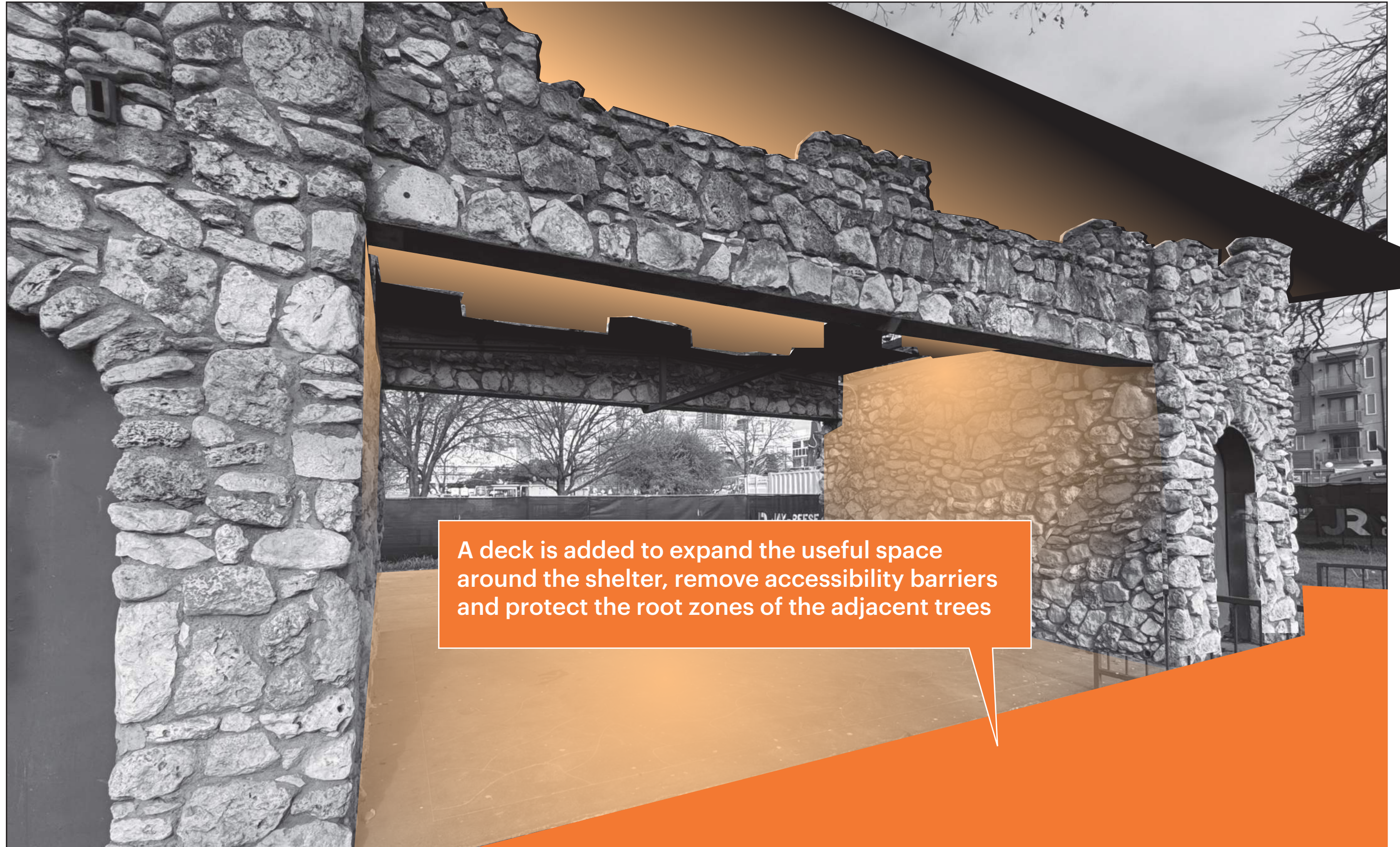

A deck is added to expand the useful space around the shelter, remove accessibility barriers and protect the root zones of the adjacent trees

Shelter House

The south side would have a family restroom and park storage

The north side would have two restrooms

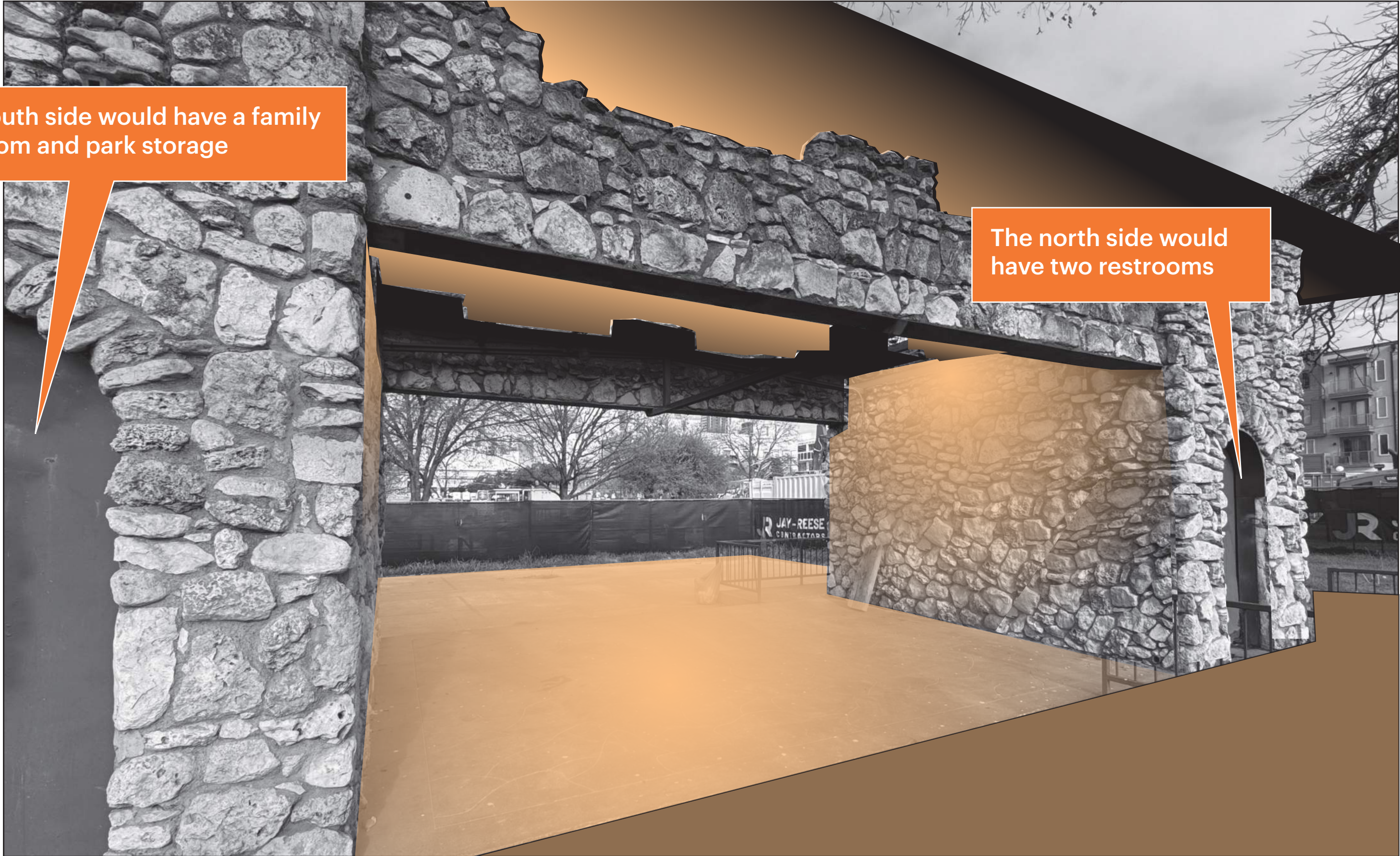

Shelter House

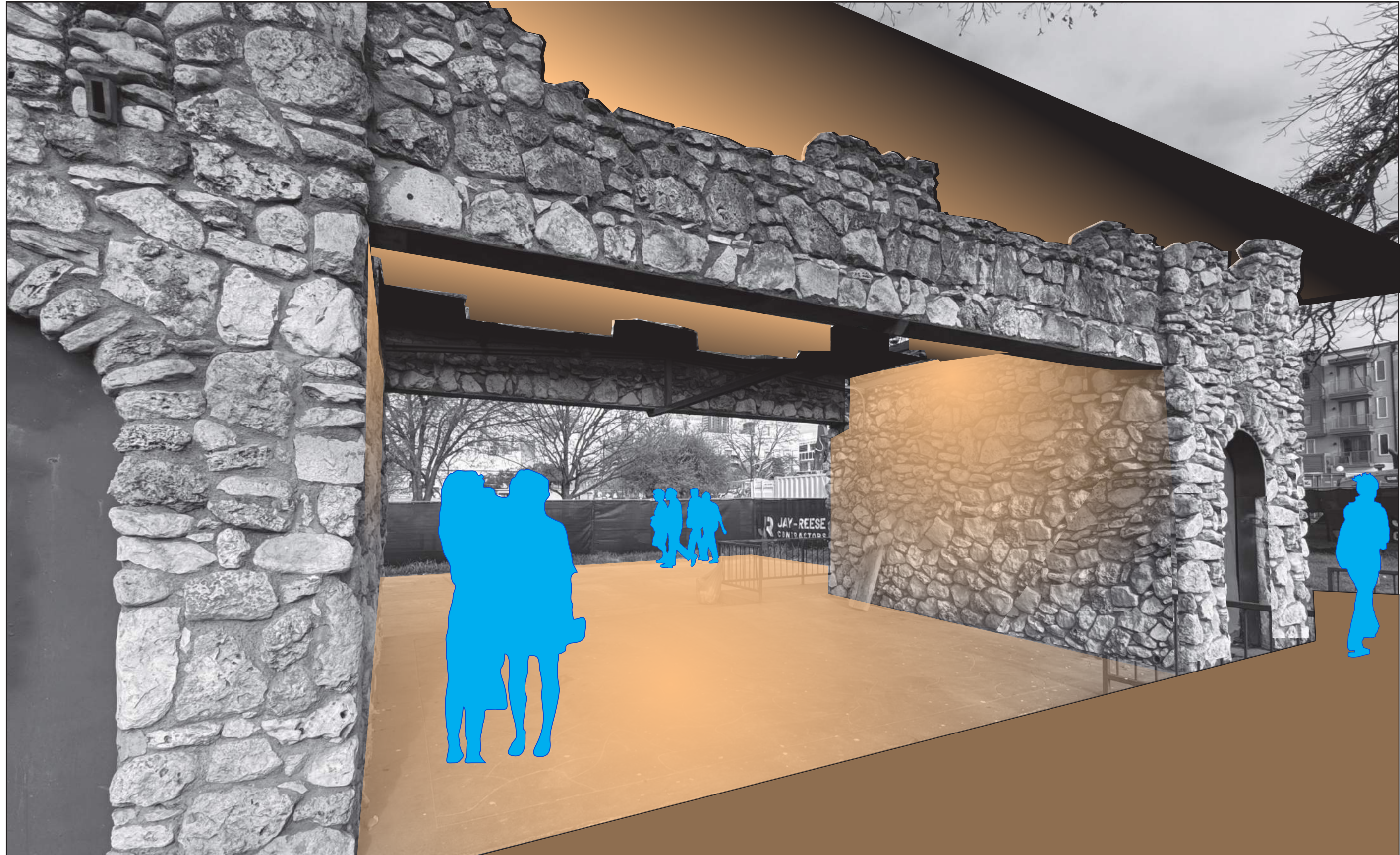

Reactivation of the Shelter House

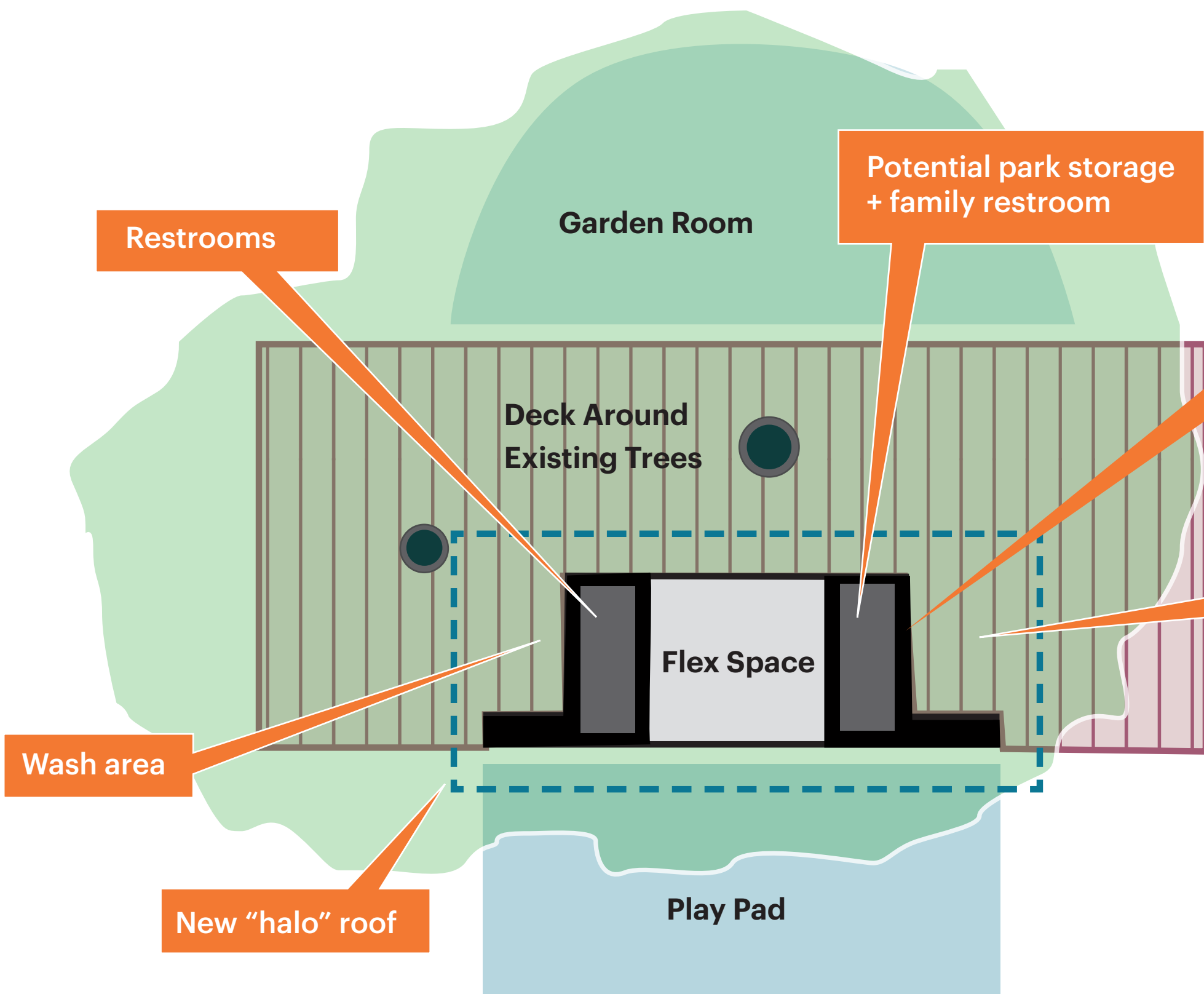

Restored stone work

Stroller storage

Four Square/ Activity Pad



Whimsical shapes on the shelter house slab invite interaction

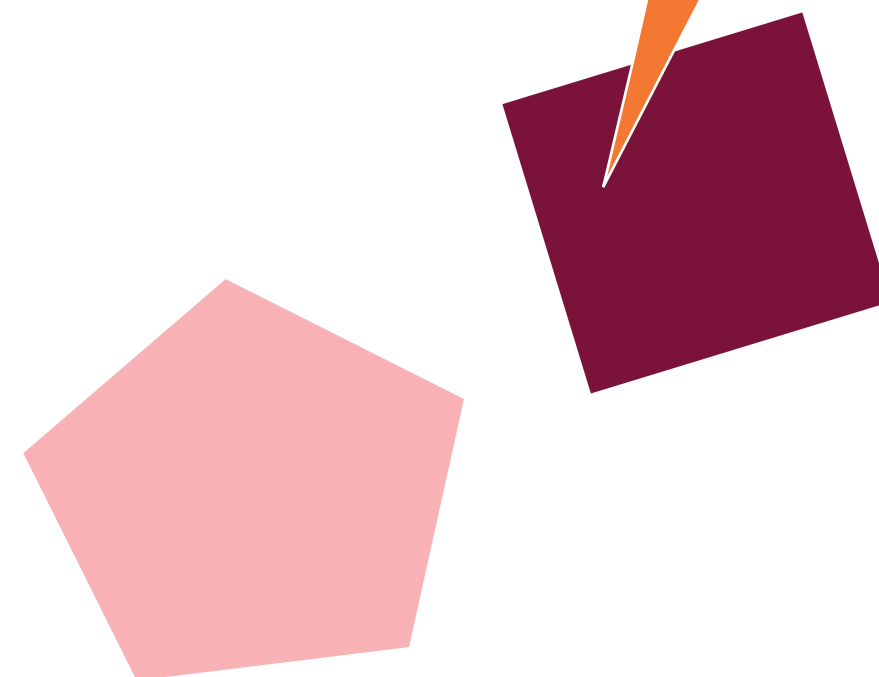
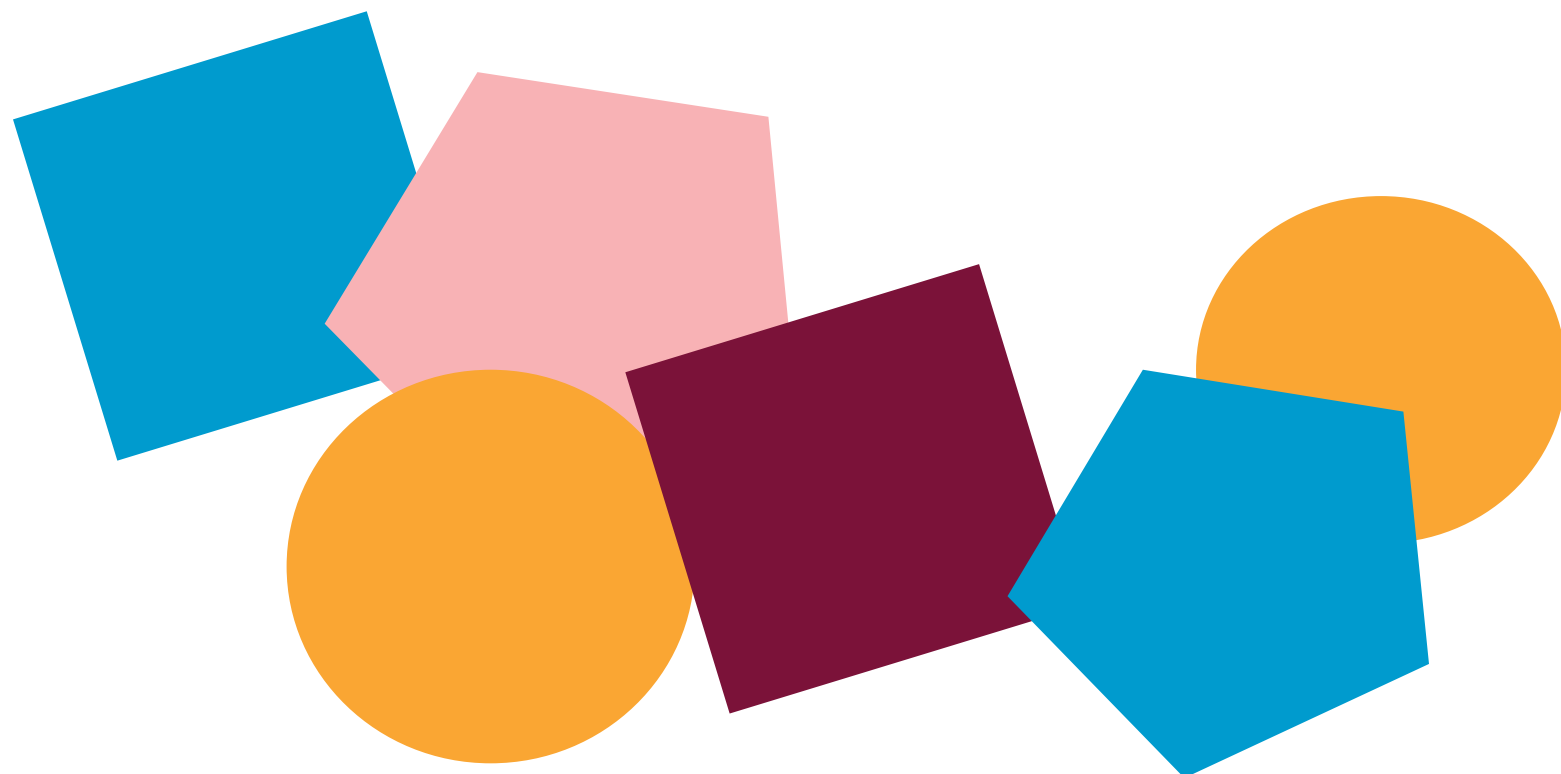

Places of Memory

"Keep historic structures"

"Replace missing pool with something to reflect its importance"

"Save the initial architecture and function it with the current fashion"

"Water fountains, restroom building"

"Record where swimming pool and movies used to be. Show history"

"Preserve notion of functionality embedded in original structure"

"Lots of shade and spaces to stop and rest"

"Put water feature where pool used to be"

"Honor the history and meaning behind the pool (share memories of the community)"

"Slab for children's games"

"Commemorate history of the pool"

"Four-square"

"Lending library"

Palm Park Pool



Palm Park Pool



Curb marked the distinctive shape of the pool on the ground

Palm Park Pool

A shade canopy is proposed as an extension from the historic shape of the pool



Palm Park Pool

The canopy would be made of a material that responds to wind and sun, recalling the movement and reflections of water



Palm Park Pool

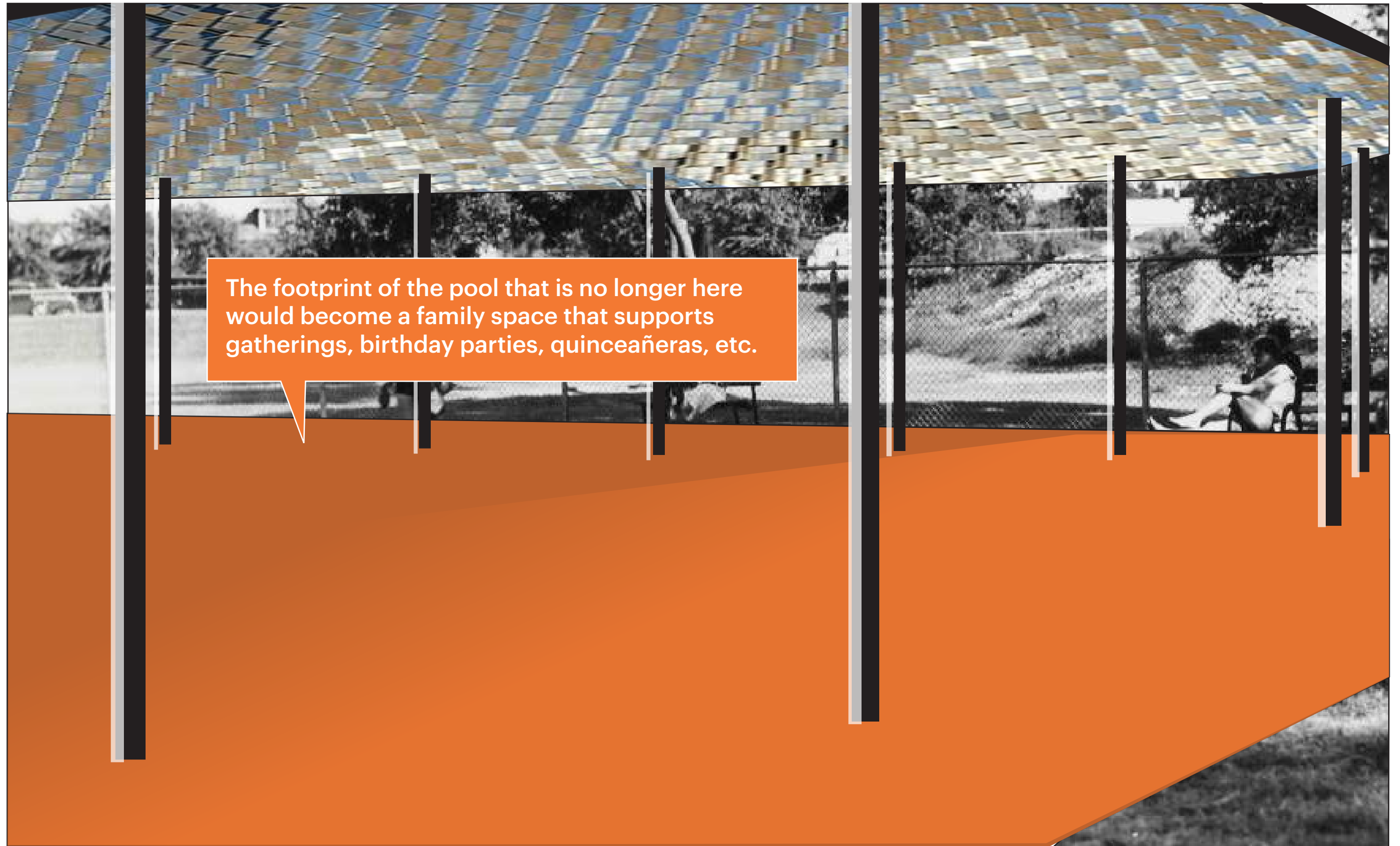

The footprint of the pool that is no longer here would become a family space that supports gatherings, birthday parties, quinceañeras, etc.

Palm Park Pool

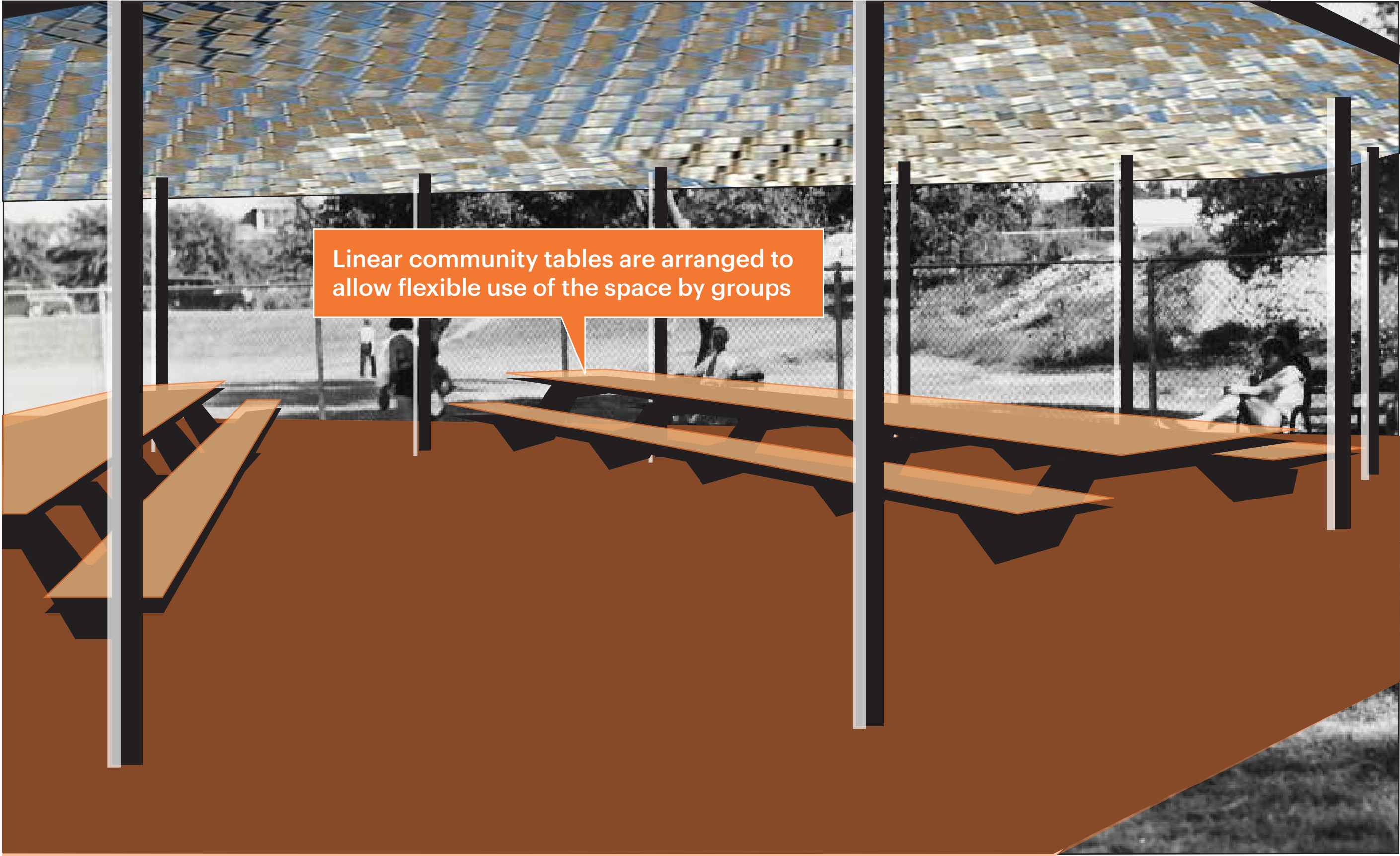

Linear community tables are arranged to allow flexible use of the space by groups

Palm Park Pool

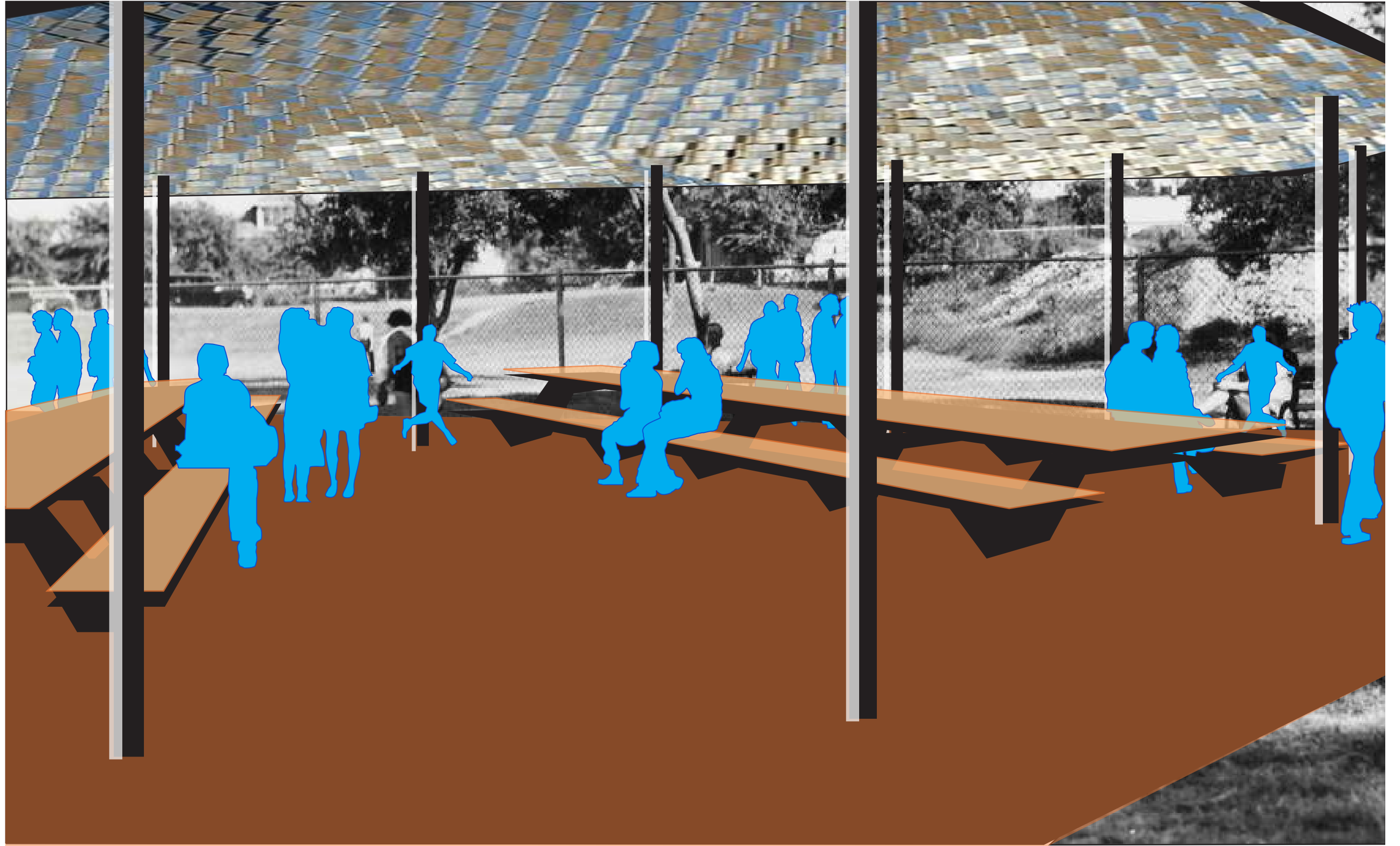

Community Tables



Community Tables

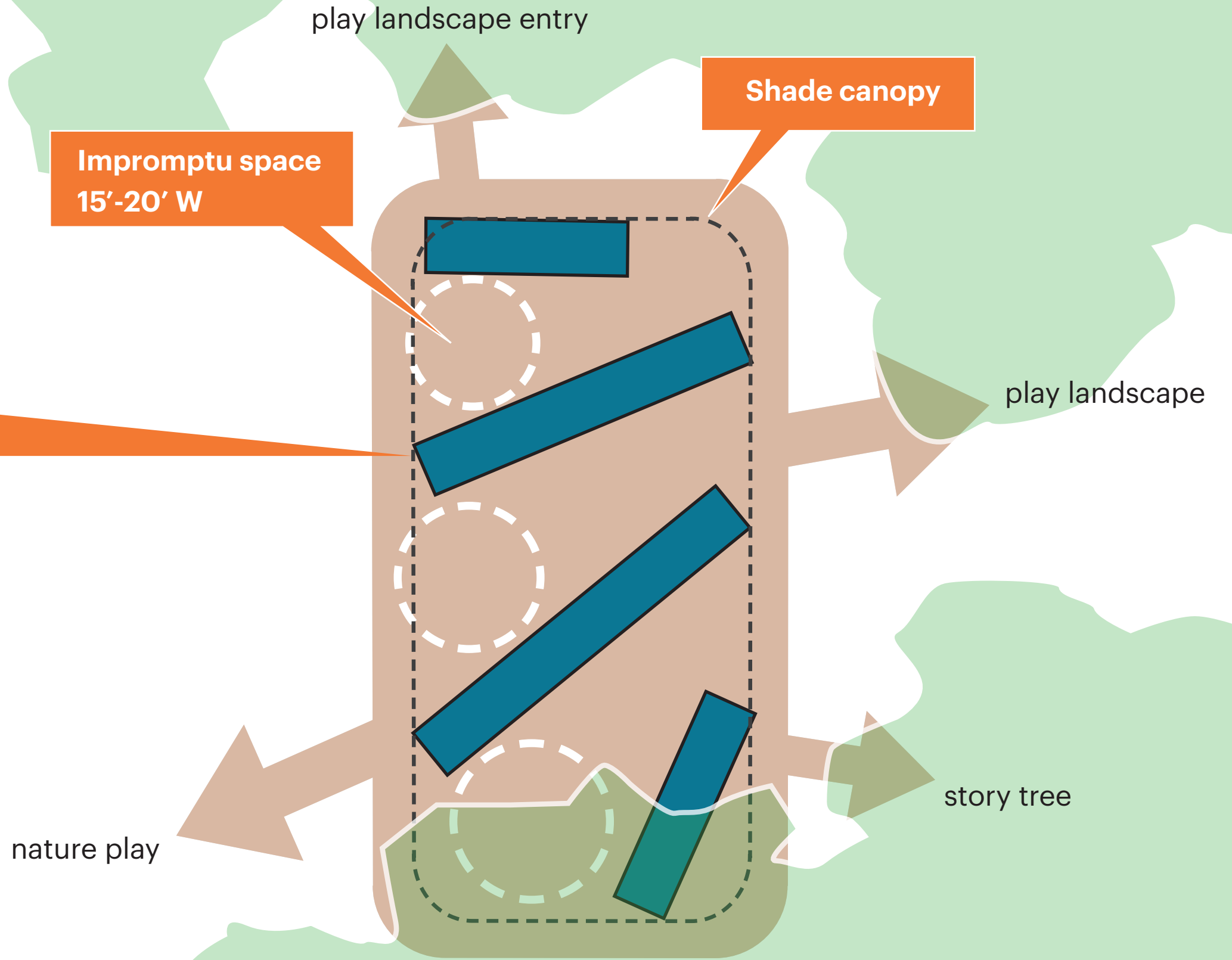

Palm Park Program: Places of Memory

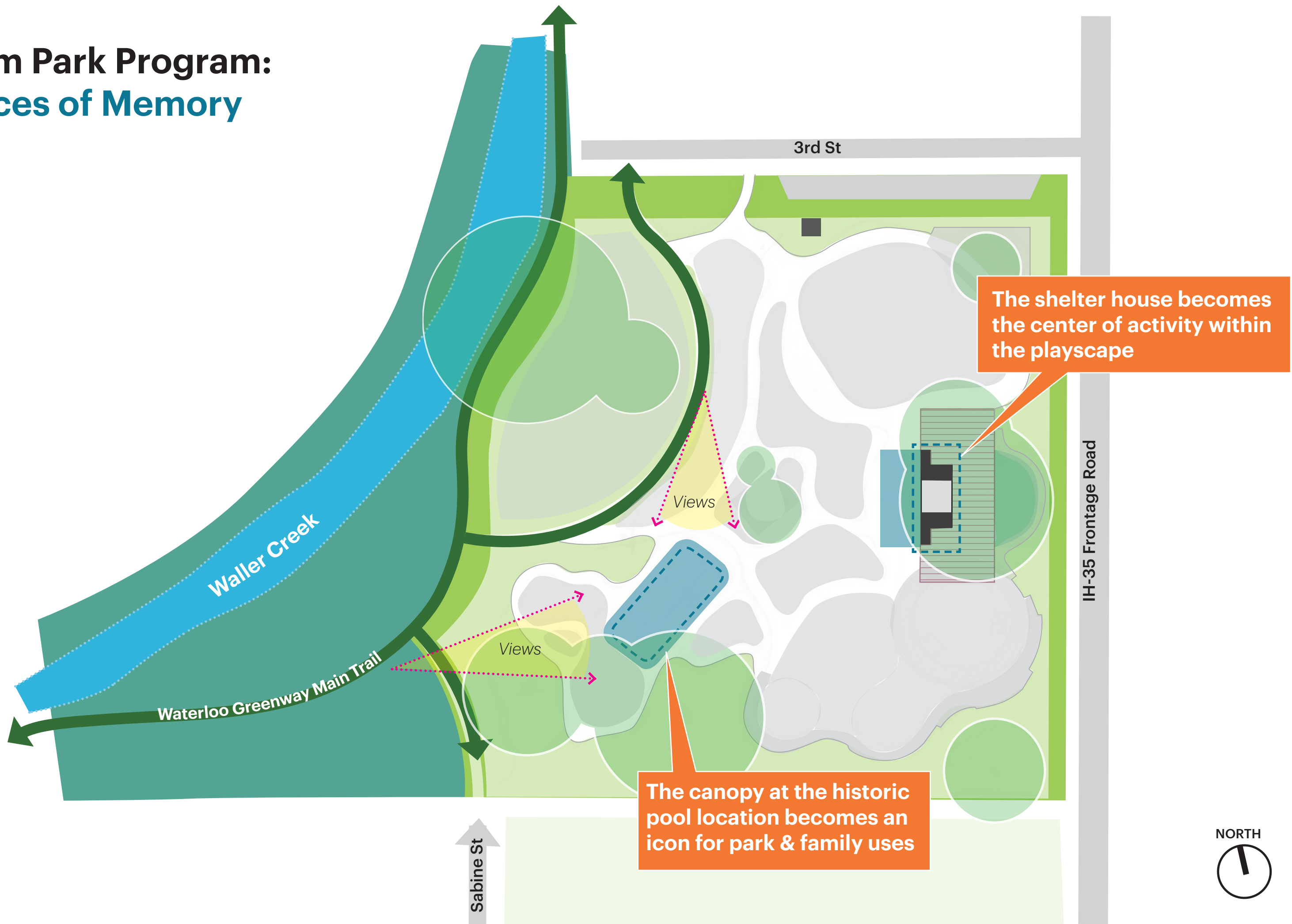

The shelter house becomes the center of activity within the playscape

The canopy at the historic pool location becomes an icon for park & family uses



Community Identity: Celebrating La Cultura

Community Identity

*"Murals,
monuments"*

*"Mexican-American
heritage should be
honored and celebrated"*

*"Walking gardens
to enjoy flowers and
vegetation (a meaningful
destination)"*

*"Integrate colors that
are representative of
the past"*

*"Mosaics, sculpture,
spaces to sit and
contemplate"*

*"Visual art;
art/sculptures"*

*"Tell the story of the park,
the neighborhood, those
that lived there"*

*"Invite local
artists (part of the
community)"*

Yards of East Austin



"Tell the story of the neighborhood..."



Yards of East Austin



Art Portals



Parque Comal



Zilker Botanical Garden



Butler Trail



Palm Park Program: Community Identity

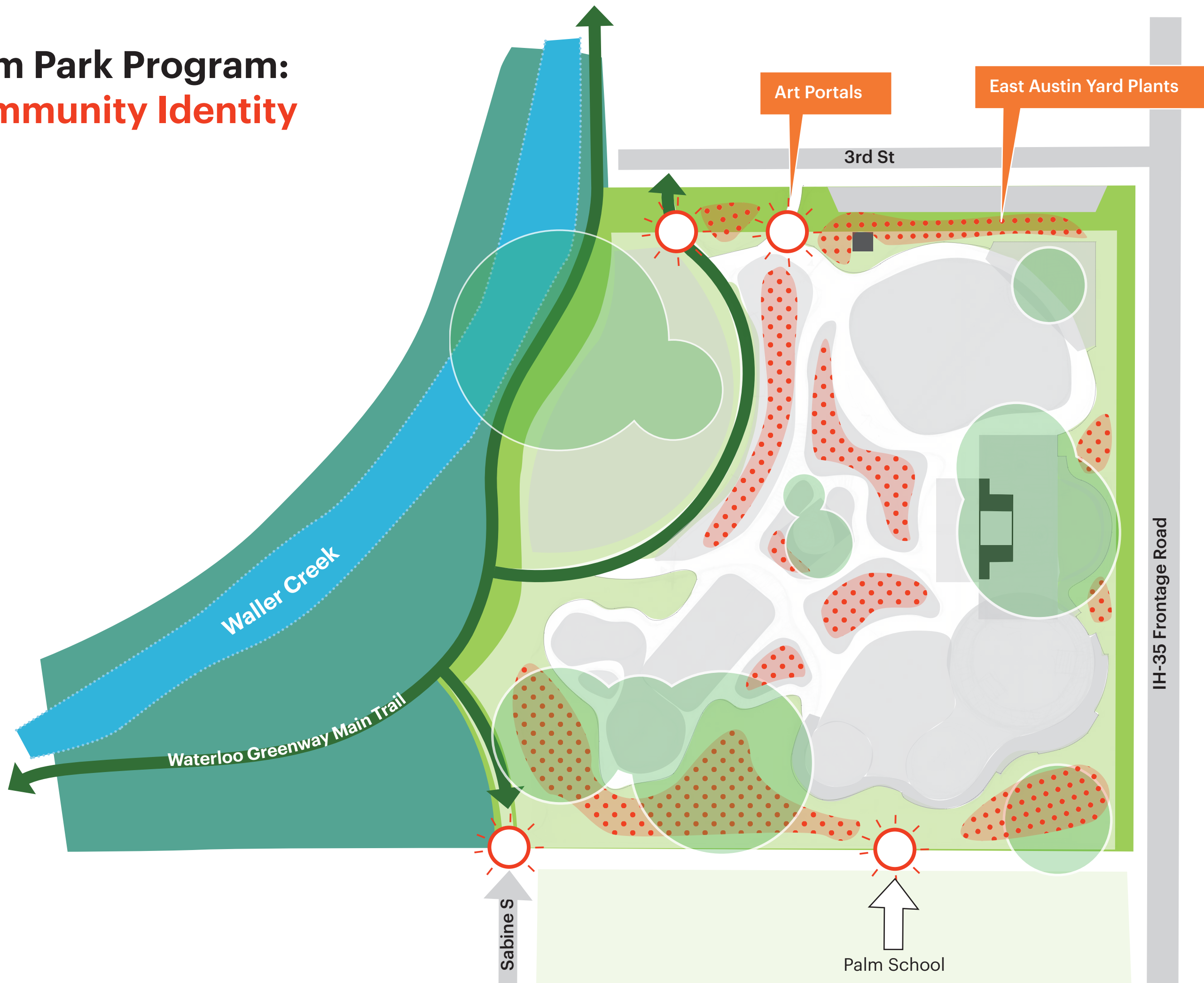

Palm Park Program:

Park Trees

Family & Play

Gathering Space

Places of Memory

Community Identity

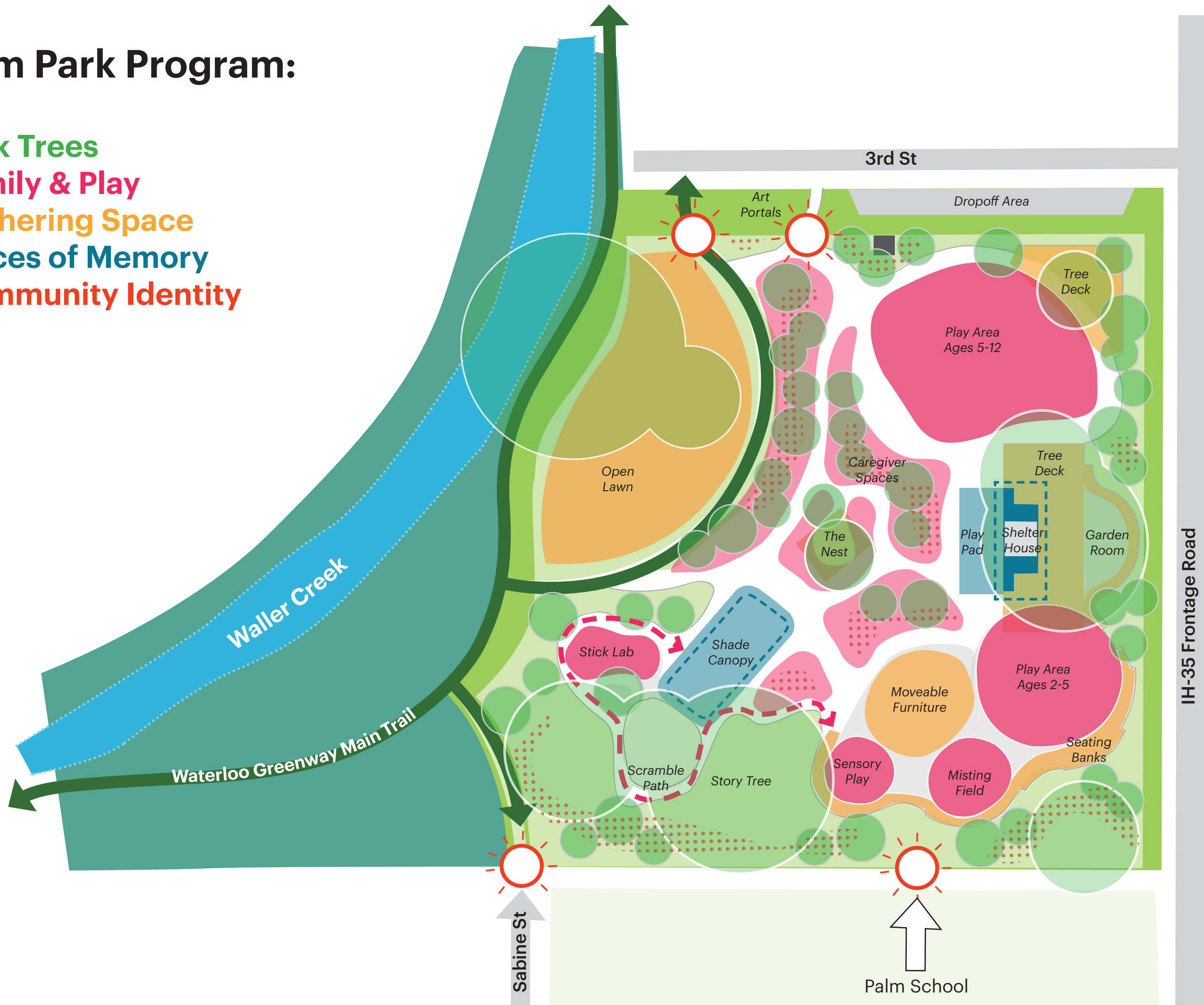

Palm Park Program Section

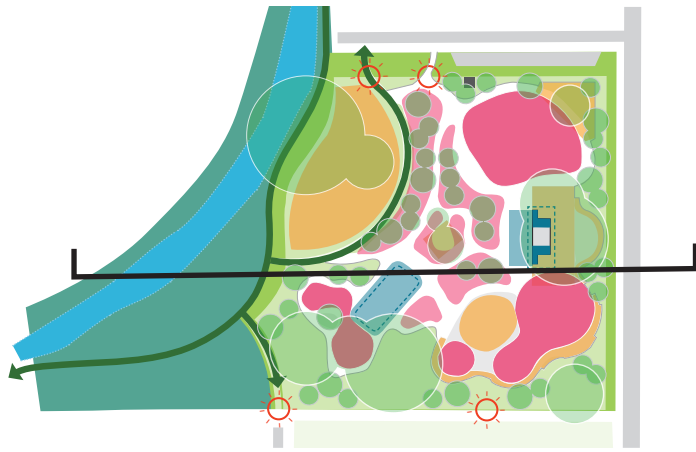

Greenway Connections



Places to Gather



The Nest



Play Pad



Larger than Life Play



Tree Decks

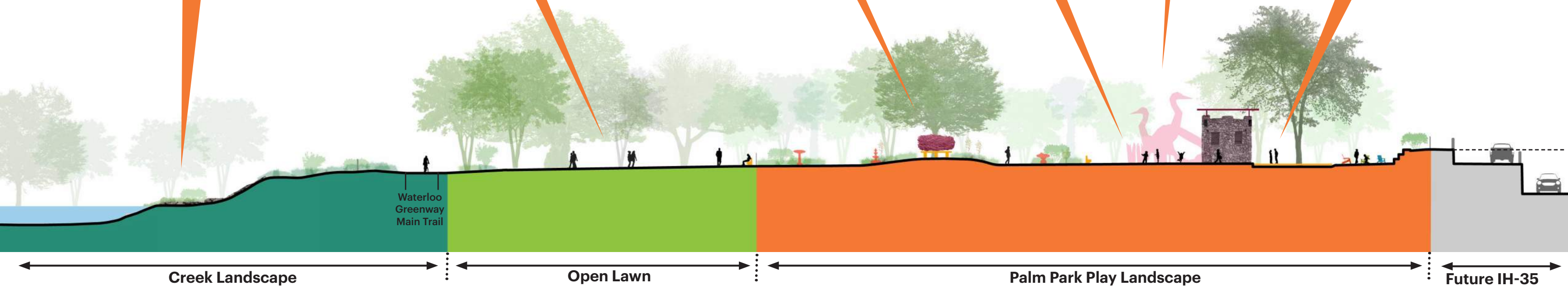

Creek Landscape

Open Lawn

Palm Park Play Landscape

Future IH-35

Waterloo
Greenway
Main Trail



Palm Park Design & Community Conversations